



06 July 2017

SDUSD - Safety Office
Attn: John Baker
4860 Ruffner Street
San Diego, CA 92111

EMA Log #: 17F0886

Project Name: EDC DW SAMPLING MONTEZUMA CDC

Enclosed are the results of analyses for samples received by the laboratory on 06/28/17 08:00. Samples were analyzed pursuant to client request utilizing EPA or other ELAP approved methodologies. I certify that this data is in compliance both technically and for completeness.

A handwritten signature in black ink, appearing to read 'Dan Verdon', is written over a light gray grid background.

Dan Verdon
Laboratory Director

CA ELAP Certification #: 2564

Client Name: SDUSD - Safety Office
Project Name: EDC DW SAMPLING MONTEZUMA CDC

EMA Log #: 17F0886

ANALYTICAL REPORT FOR SAMPLES

Sample ID	Laboratory ID	Matrix	Date Sampled	Date Received
SAMPLE POINT #1	17F0886-01	Drinking Water	06/28/17 06:00	06/28/17 08:00
SAMPLE POINT #2	17F0886-02	Drinking Water	06/28/17 06:00	06/28/17 08:00
SAMPLE POINT #3	17F0886-03	Drinking Water	06/28/17 06:00	06/28/17 08:00
SAMPLE POINT #4	17F0886-04	Drinking Water	06/28/17 06:00	06/28/17 08:00
SAMPLE POINT #5	17F0886-05	Drinking Water	06/28/17 06:00	06/28/17 08:00

The results in this report apply to the samples analyzed in accordance with the chain of custody document. This analytical report must be reproduced in its entirety.

Client Name: SDUSD - Safety Office
Project Name: EDC DW SAMPLING MONTEZUMA CDC

EMA Log #: 17F0886

Total Metals by EPA 200 Series Methods

Analyte	Result	Reporting Limit	Units	Dilution	Batch	Prepared	Analyzed	Method	Notes
SAMPLE POINT #1 (17F0886-01) Drinking Water Sampled: 06/28/17 06:00 Received: 06/28/17 08:00									
Lead	0.010	0.005	mg/l	1	7062935	06/29/17	07/05/17	EPA 200.8	
SAMPLE POINT #2 (17F0886-02) Drinking Water Sampled: 06/28/17 06:00 Received: 06/28/17 08:00									
Lead	0.053	0.005	mg/l	1	7062935	06/29/17	07/05/17	EPA 200.8	
SAMPLE POINT #3 (17F0886-03) Drinking Water Sampled: 06/28/17 06:00 Received: 06/28/17 08:00									
Lead	ND	0.005	mg/l	1	7070552	07/05/17	07/05/17	EPA 200.8	
SAMPLE POINT #4 (17F0886-04) Drinking Water Sampled: 06/28/17 06:00 Received: 06/28/17 08:00									
Lead	ND	0.005	mg/l	1	7070552	07/05/17	07/05/17	EPA 200.8	
SAMPLE POINT #5 (17F0886-05) Drinking Water Sampled: 06/28/17 06:00 Received: 06/28/17 08:00									
Lead	0.005	0.005	mg/l	1	7070552	07/05/17	07/05/17	EPA 200.8	

The results in this report apply to the samples analyzed in accordance with the chain of custody document. This analytical report must be reproduced in its entirety.

Sample Locations acknowledgement

School and Address: Montezuma Child Development Center, 4950 Curry Dr., San Diego, CA 92115

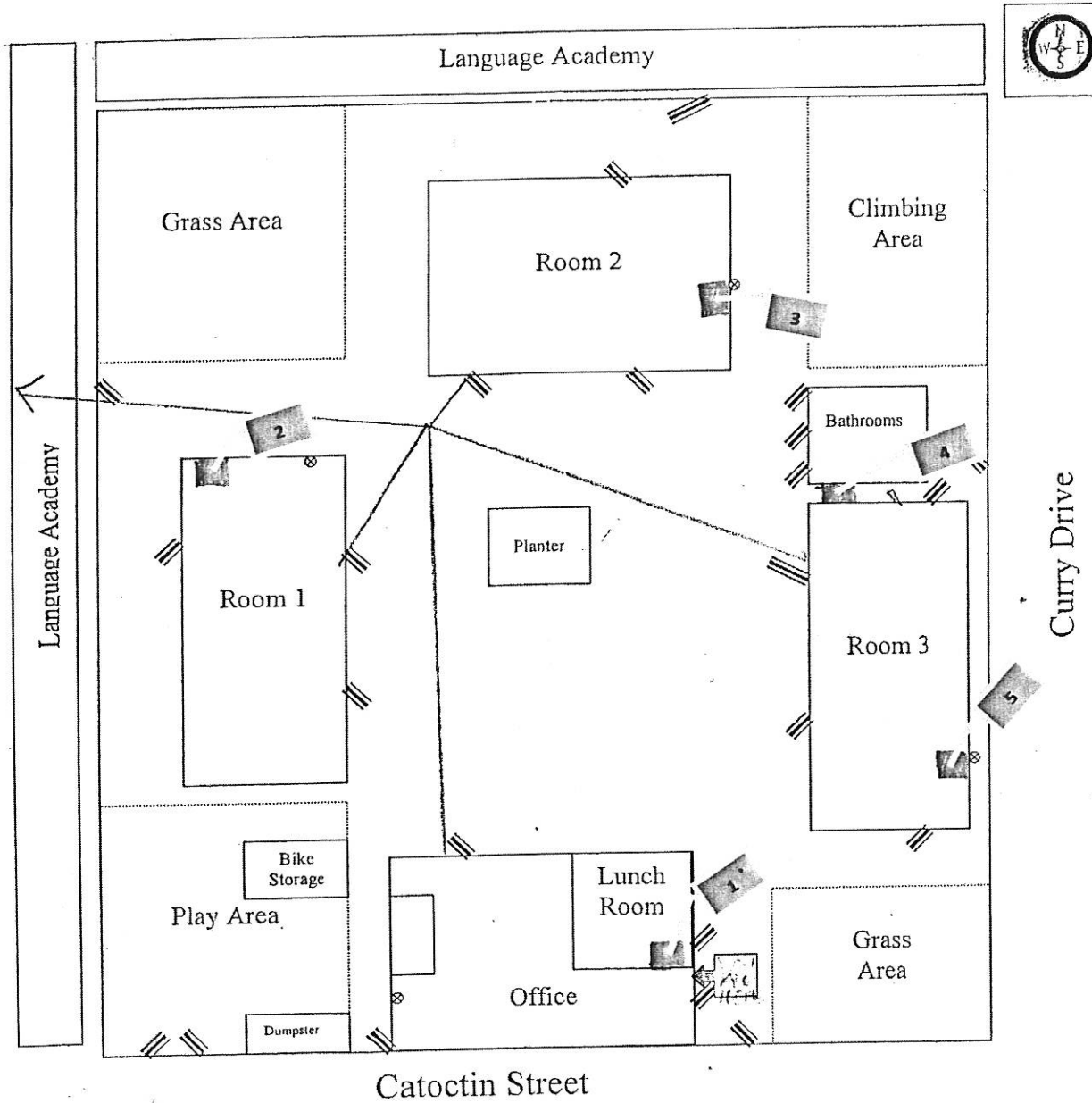

⊗ Water and Gas △ Electrical □ Master Key

Outside Building Sketch with Utility Locations
Montezuma Child Development Center